



# INSTRUCTION BULLETIN

No. 340267  
Machine: 6200  
Published: 3-99/00  
System: OPTIONS

**NOTE: DO NOT DISCARD the Parts List from the Instruction Bulletin. Place the Parts List in the appropriate place in your machine manual for future reference. Retaining the Parts List will make it easier to reorder individual parts and will save you the cost of ordering an entire kit.**

*NOTE: Numbers in parenthesis ( ) are reference numbers for parts listed in Bill of Materials.*

Installation instructions for kit number 384131

## **SYNOPSIS / PROBLEM:**

This kit contains the parts needed to install a backup alarm kit on the model 6200 sweeper. Please follow step-by-step instructions.

## **SPECIAL TOOLS / CONSIDERATIONS: NONE**

(Estimated time to complete: 1 hour)

## **PREPARATION:**

(Refer to FIG. 1 thru 4)

**FOR SAFETY: Before leaving or servicing machine, stop on level surface and set parking brake. Then turn off machine and remove key.**

1. Disconnect battery cables from machine.



**WARNING: Always disconnect battery cables from machine before working on electrical components.**

## **INSTALLATION:**

(Refer to FIG. 1 thru 4)

1. Locate the horn mounting locations shown in figure one. (Refer to FIG. 1)

*NOTE: The horn will mount on the light mounting bracket, as shown in the lower drawing, if the machine is equipped with a warning light option.*

2. Wire the horn (1) into the main wiring harness. (Refer to FIG. 4)
3. Mount the horn (1) to the machine with hex screws (2), washers (3), and lock nuts (4). (Refer to FIG. 1)
4. Mount the roller switch assembly (6) to the switch mounting bracket (5) with hex screws (7), lock washers (8), and flat washers (9). (Refer to FIG. 2)
5. Remove and set aside the propelling pedal mounting hardware. (Refer to FIG. 1 and 3)
6. Turn the pedal upside down. Mount the roller switch/switch mounting bracket to the propelling pedal. (Refer to FIG. 1 and 3)
7. Connect the roller switch to the main wiring harness.
8. Remount the propelling pedal to the machine.

9. Reconnect battery cables. Check the machine and back up alarm for proper operation.

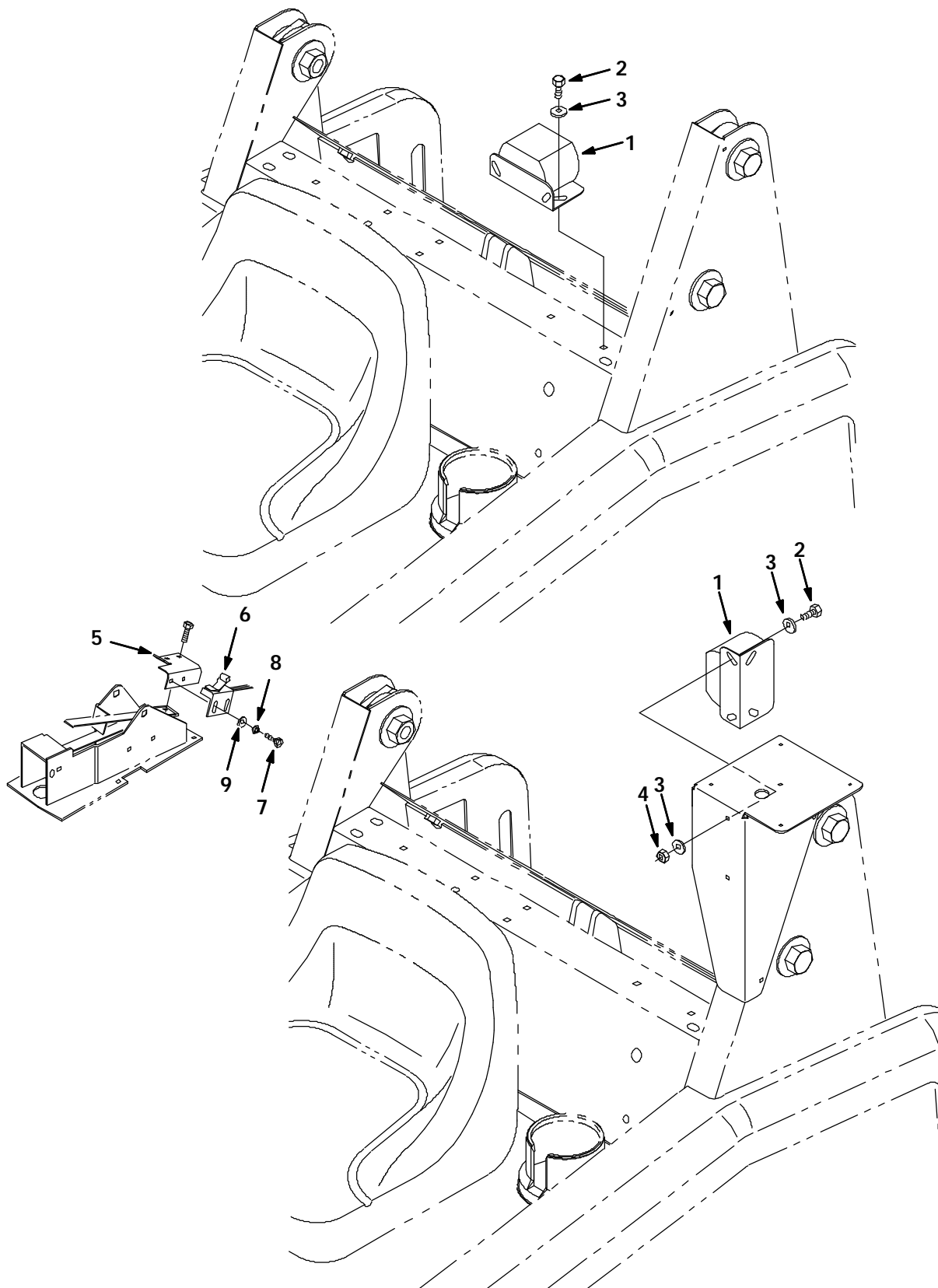

**FIG. 1 - BACK UP ALARM INSTALLATION**

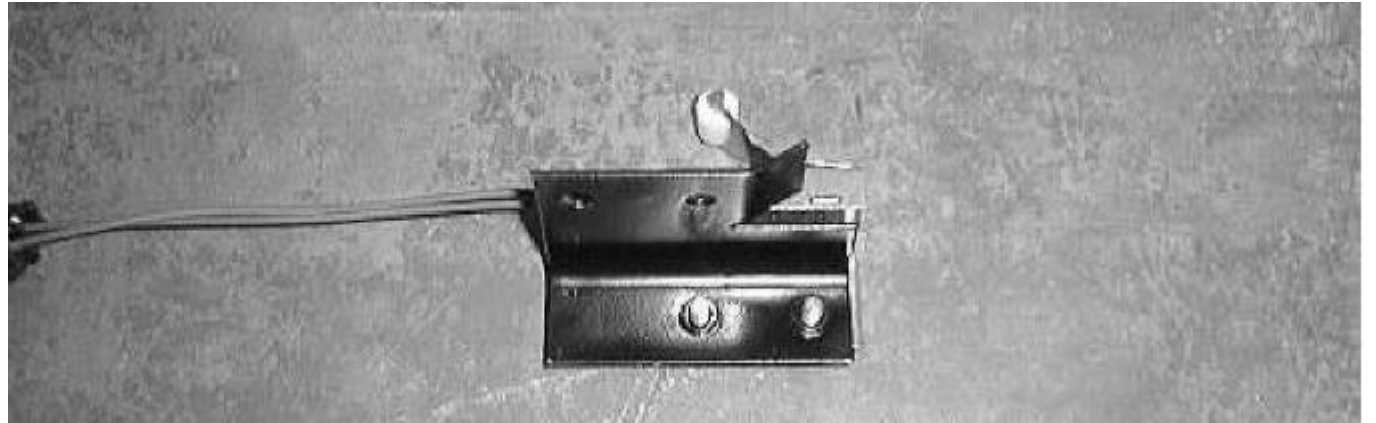
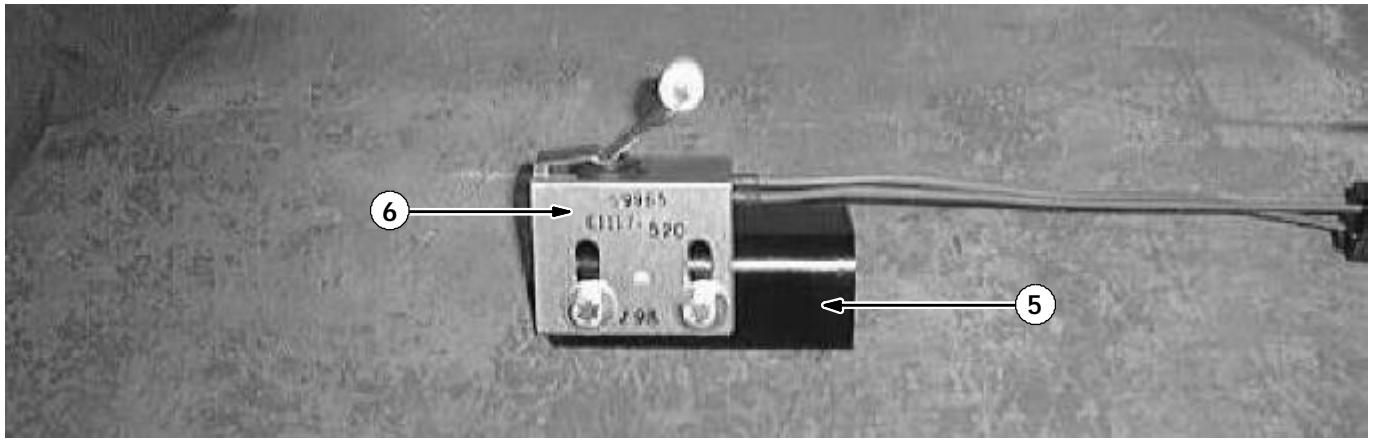

**FIG. 2 - MOUNT ROLLER SWITCH TO MOUNTING BRACKET**



**FIG. 3 - MOUNT SWITCH ASSEMBLY TO PROPELLING PEDAL**

